



MIDDLETOWN
Rhode Island

TOWN ADMINISTRATOR

TOWN OF MIDDLETOWN

350 East Main Road, Middletown, RI 02842
(401) 842-6500 | MiddletownRI.com

To: Members of Middletown Town Council

From: Shawn J. Brown, Town Administrator

Date: September 28, 2024

Re: ROW Parking on Wolcott Avenue

The current situation with people trying to park to access the CRMC right of ways to the shore along Tuckerman Avenue is having a negative impact on the lower Easton's Point neighborhood, disrupting the residents' quality of life and serenity.

In order to manage the parking situation, recommend that two parking spots be located at the southwest end of Wolcott Avenue. Parking would be limited to four hours during daylight hours (sunrise to sunset). Vehicles would be required to have a resident parking sticker similar to the requirements at the Y-9 ROW access at the west end of Purgatory Road next to Dunlop-Wheeler Park.

We would work with Kevin Perhamus, 629 and 639 Wolcott Avenue, to identify a solution that complements the potential use of the property he owns adjacent to the project area.

For reference, I have attached:

1. GIS visual with Crossman survey information that identifies the public ROW for parking spots;
2. Memo dated 12/18/23 from Kevin Perhamus with a proposal for addressing parking and shoreline access issues at Y-11 right of way, and;
3. Memo dated 3/26/21 from Town Administrator "Amended Parking Restrictions – Wolcott Ave".



December 18, 2023

Subject: Proposal for Addressing Parking and Shoreline Issues at Y-11 Right of Way

Dear Town Council Members,

Thank you again for hosting the workshop on Coastal Right of Ways on November 21st. It was an insightful session that highlighted various issues, including those at the Y-11 right of way (at the corner of Wolcott and Tuckerman), which I believe can be improved with a singular solution.

Parking Issue: My wife and I, residing at 629 Wolcott and owning the adjacent lot at 639 Wolcott, face direct challenges due to undefined parking rules at this corner. The area often becomes littered with trash, and cars are parked haphazardly on our lawn at all hours. This not only damages the lawn we maintain but also disrupts neighborhood peace and poses safety concerns.

Shoreline Issue: Several neighbors have raised similar concerns about the misuse of the shoreline, noting problems such as littering, noise disturbances, and safety worries, primarily from visitors parking at the corner of Wolcott and Tuckerman.

As advocates for coastal access and regular users of the Y-11 right of way, we seek to improve shoreline accessibility while also enhancing neighborhood conditions. As discussed in the workshop, a right of way doesn't necessarily require the establishment of parking spaces.

Proposal: I propose the creation of two parking spots designated for Middletown residents only on (in front of) our property at 639 Wolcott, akin to the Dunlop-Wheeler parking model near the Y-9 ROW (Ordinance 72.40). Parking would be limited to 4 daytime hours. This includes establishing a defined parking area with aesthetic considerations such as crushed stones and wooden borders. The 2 parking spots would be positioned close to the corner (stop sign) to allow a driveway to be added in the future (see figure 1). We met with Ron Wolanski about subdivision and driveway location on December 5, 2023.

Funding: I am committed to mobilizing private funding for this project to minimize the financial burden on our taxpayers.

Thank you for considering my proposal. I look forward to contributing to our community's enhanced beauty and accessibility.

Sincerely,

Kevin Perhamus
629 & 639 Wolcott Avenue

Appendix



Proposed Parking location on the west side of Wolcott avenue at the corner of Wolcott and Tuckerman for Middletown residents.

December 18, 2023

Example of Middletown Resident Parking at Dunlop-Wheeler Park



Middletown Resident Only Parking sign at the Dunlop-Wheeler park near ROW Y-9. Ordinance on Parking regulation 72.40.

§ 72.40 PARKING AT DUNLAP-WHEELER PARK.

⋮

No person shall park a vehicle for a period of time longer than four consecutive hours between the hours of sunrise and 4:00 p.m. at the Dunlap-Wheeler Park parking area. Such parking shall be limited to holders of a Middletown resident beach parking pass issued under the provisions of § [72.36](#) (and all descendants of the Dunlap and Wheeler families). Parking is reserved for noncommercial purposes only. No employees or owner of a business shall use said lot for work related parking. At least one space in such lot shall be designated as reserved for persons with disabilities.

(Ord. passed 8-19-02; Am. Ord. passed 4-19-04)

December 18, 2023

A typical Saturday. Many cars parked on the lawn without organization.



There is free parking and shoreline access for fishing at the National Wildlife Refuge nearby. We should provide information (signage or flyers) with directions to the refuge.



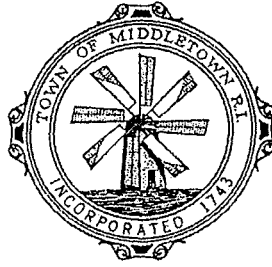

MEMO

To: Town Council
Cc: Police Chief
From: Town Administrator *JAB*
Subject: Amended parking restrictions – Wolcott Ave
Date: March 26, 2021

The number of vehicles parking in the Tuckerman/Wolcott intersection vicinity has negatively impacted the residents' quality of life. Late-night activity in the neighborhood has contributed to residents' concern for their safety. The administration recommends that the Council amend the parking regulations - specifically, the administration recommends the following:

- Restrict parking to an area located at the south-west end of the street – *parking is currently allowed in this area*
- Parking would be limited to a length of fifty-eight linear feet, or approximately three car lengths – *the size of the area would be delineated, whereas it is currently opaque*
- No parking would be allowed between 9 PM and 5 AM – *there is currently no time restrictions*
- Parking would be limited to 2-hours – *there is currently no time limitation*

I have attached a drawing that represents the proposed amendment. We look forward to reviewing this proposal with you at the upcoming meeting.

Attachment

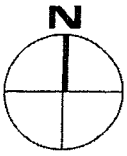

- (A) EXISTING SIGN:
NO PARKING ON
ROADWAY / CURVE
- (B) EXISTING SIGN:
NO PARKING

(C)
STONES OR
BOLLARDS TO WITHIN
15' OF FIRE HYDRANT

NEW SIGN:
PARKING ONLY BETWEEN
SIGNS, MAXIMUM 2 HOURS
NO PARKING BETWEEN
9 PM THRU 5 AM
TOW ZONE

3 @ 9'x18' PARKING
SPACES

NEW SIGN:
PARKING ONLY BETWEEN
SIGNS, MAXIMUM 2 HOURS
NO PARKING BETWEEN
9 PM THRU 5 AM
TOW ZONE

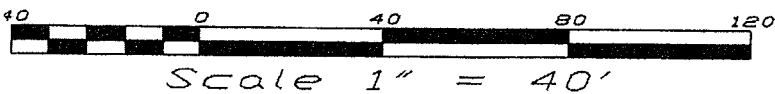
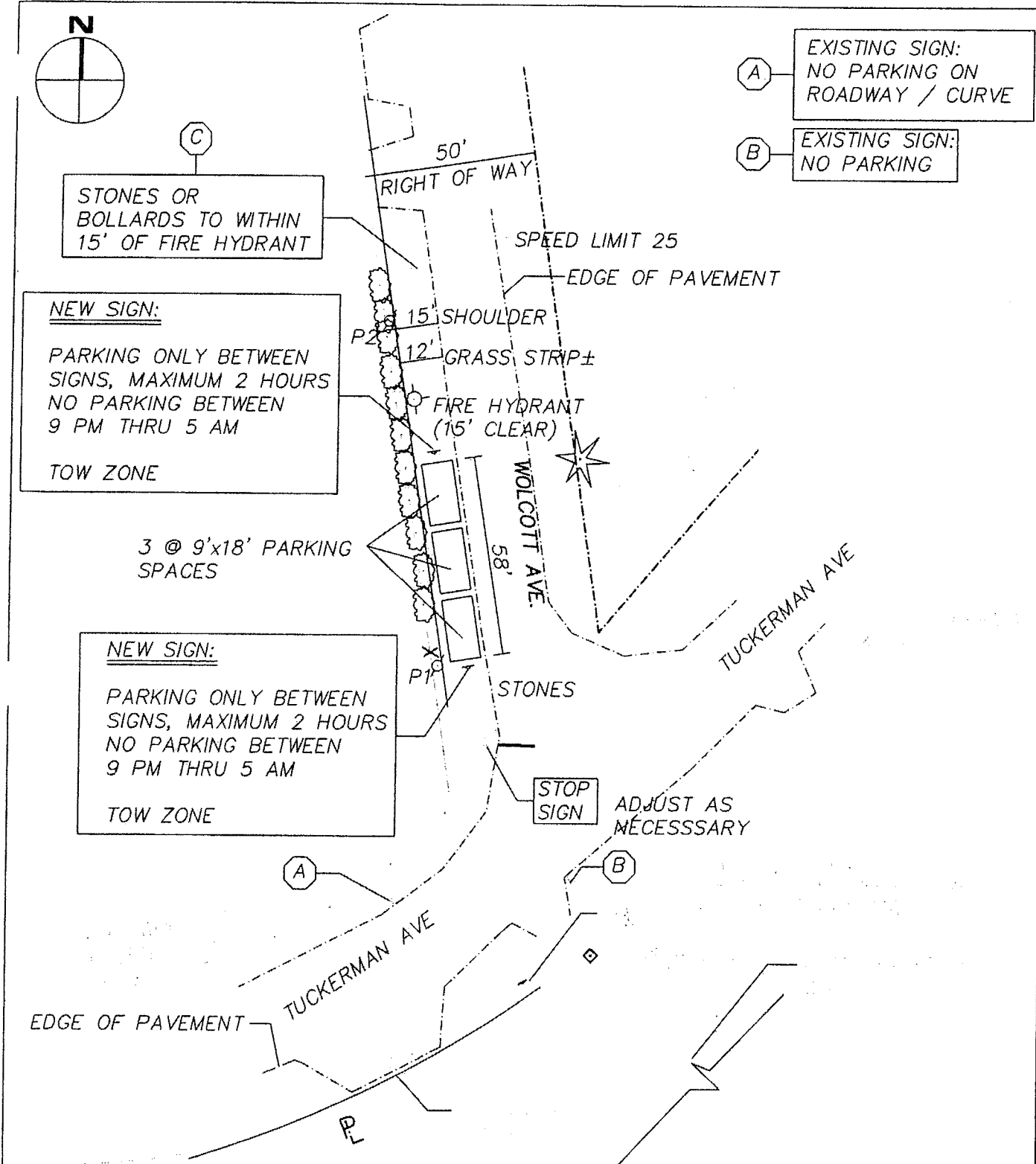

TOWN OF MIDDLETOWN:
PROPOSED PARKING SPACES
WOLCOTT AVE x TUCKERMAN AVE
MARCH 26, 2021 BY: WFH
SHEET 1 OF 1